

### ProSAFE Plus 16-Port Gigabit Switch GS116Ev2

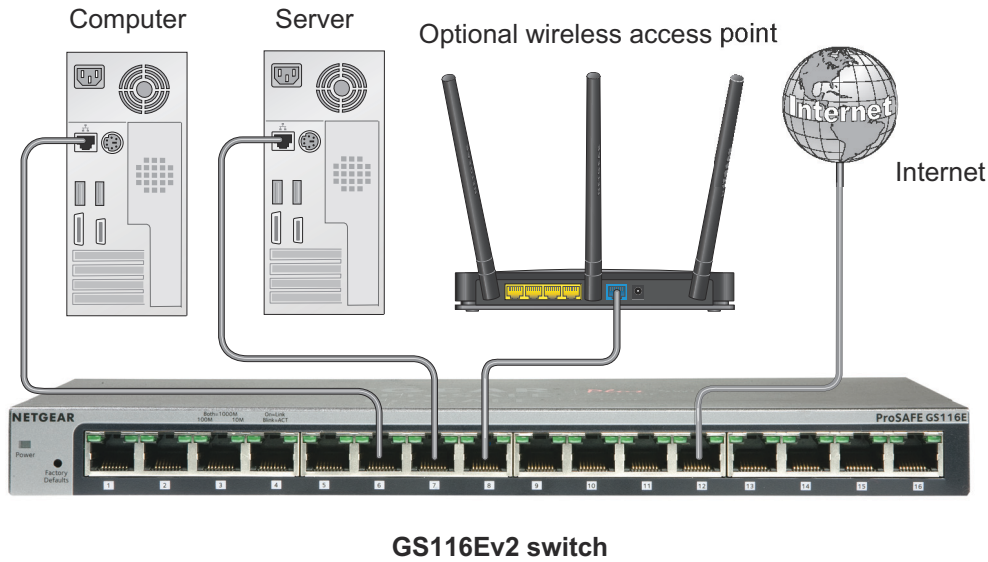

#### Step 1. Connect equipment.



#### Step 2. Connect power.

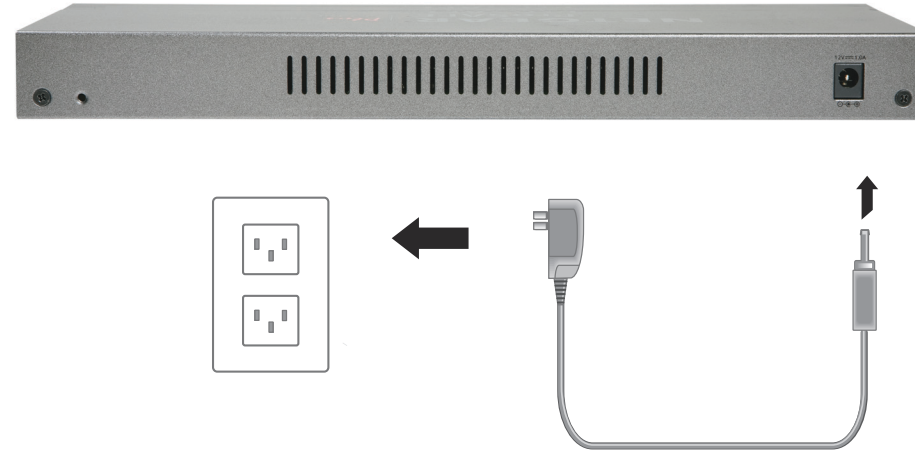

#### Step 3. Check status.



##### Power LED

- On
- Off

##### Port LEDs

- ● 1000 Mbps link (both LEDs)
- 100 Mbps (left LED)
- 10 Mbps (right LED)
- Activity (blinking)
- No link (off)

## Set Up the Switch Configuration Utility

Plus switches are plug and play. You can install a configuration utility to select additional options to manage and customize the switch for your network. This utility is on the resource CD that was shipped with the switch.

**Note:** The configuration utility is installed on your computer and is supported only on Windows computers.

### To install the configuration utility:

1. Insert the resource CD into a computer that is connected to the switch.
2. Click **Install ProSAFE Plus Utility** and follow the prompts to install the program.

The switch configuration utility is installed in the program directory of your computer and a **ProSAFE Plus Utility** icon is placed on your desktop.

### To configure the switch:

1. Double-click the **ProSAFE Plus Utility** icon.  
The configuration home screen displays a list of plus switches that it discovers on the local network.
2. Select the switch that you want to configure.  
You are asked to enter the password for the switch.
3. Enter the switch's password in the password field.  
The switch's default password is password.
4. Use the utility to configure the switch.

For a description of plus features, see the *ProSAFE Plus Switch Utility User Guide*. You can access the user guide through links on the Help tab of the utility or on the resource CD.

## Specifications

Specification	Description
Network interface	RJ-45 connector for 10BASE-T, 100BASE-TX, or 1000BASE-T
Network cable	Category 5e (Cat 5e) or better Ethernet cable
Ports	16
Power	12V @ 1.0A DC input
Power consumption	10W maximum
Weight	0.84 kg (1.86 lb)
Dimensions (W x D x H)	286 mm x 101 mm x 25.9 mm (11.30 in. x 3.98 in. x 1.02 in.)
Operating temperature	0–50° C (32–122° F)
Operating humidity	10%–90% relative humidity, noncondensing
Electromagnetic compliance	KC Class A, CCC Class A, FCC part 15 Class A, C-Tick Class A, CE Class A, VCCI Class A
Safety agency approvals	CB, CE LVD

## Support

Thank you for selecting NETGEAR products.

After installing your device, locate the serial number on the label of your product and use it to register your product at <https://my.netgear.com>.

You must register your product before you can use NETGEAR telephone support. NETGEAR recommends registering your product through the NETGEAR website. For product updates and web support, visit <http://support.netgear.com>.

NETGEAR recommends that you use only the official NETGEAR support resources.

For the current EU Declaration of Conformity, visit [http://support.netgear.com/app/answers/detail/a\\_id/11621/](http://support.netgear.com/app/answers/detail/a_id/11621/).

CAN ICES-3 (A)/NMB-3(A)



201-17387-01

NETGEAR, Inc.  
350 East Plumeria Drive  
San Jose, CA 95134 USA

July 2013

NETGEAR, the NETGEAR logo, and Connect with Innovation are trademarks and/or registered trademarks of NETGEAR, Inc. and/or its subsidiaries in the United States and/or other countries. Information is subject to change without notice. © NETGEAR, Inc. All rights reserved.